

2023 Start of Year Info



www.thegardens.school.nz

25th January, 2023

A special welcome to all the new families joining The Gardens School in 2023.

In order to ensure a smooth start back to school for everyone, please make sure you have familiarised yourself with all the information in this newsletter, as there are specific details for different year levels.

First Day Procedures

ALL students are to make their way to the **school hall from 8.20am on Tuesday 31st January**. Entry will be via the doors closest to the basketball court. Staff will point you in the right direction if you are unsure where to go.

Hapori Leaders and teachers will be in the hall to welcome students and line them up in their Hapori groups. Parents can either drop off, or are welcome to wait in the hall while the classes are organised. There will be many staff on hand to help with anxious students and first day nerves, and we highly recommend the coffee at Cafe Aroha for any parents who might have first day nerves themselves :)

At 8.50am we will begin moving students to their learning spaces and our school day will begin.

What to Bring

Please make sure your child is prepared for the start of the new school year, in their correct school uniform and with their stationery pack, ready for the day. They will need their **school hat**, morning tea and lunch packed in their own named lunchbox and a named water bottle.

Pick Up - End of Day

School ends at 2.50pm. Years 3-8 students are dismissed into Central Park and parents/caregivers are welcome to wait in this area to collect them. Central Park can be accessed via the path behind the caretakers shed, from the top field, from the pedestrian path beside the shops or via the bottom gate at Arua Park (closest to the caretakers shed).

Kiwi and Kākāpō (Year 1 and 2) - We continue to offer an **OPTIONAL** early pick up for students in Kiwi (Year 1) and Kākāpō (Year 2). Children in these teams can be collected at **any time between 2.30pm and 2.50pm**. Pick up of all Kiwi and Kākāpō children is from the Arua Park gate closest to the office. **Please wait outside the gate** and your child will be brought out to you. Please note there is no parent access into Arua Park at this gate.

We have provided a map on the next page to indicate the pick up points. The green lines indicate how to access Central Park if you are picking up students in Year 3-8.

Children who attend After School Care go directly to the Weka block after school. Year 1 and 2 students are taken by a staff member.

Pick Up Points

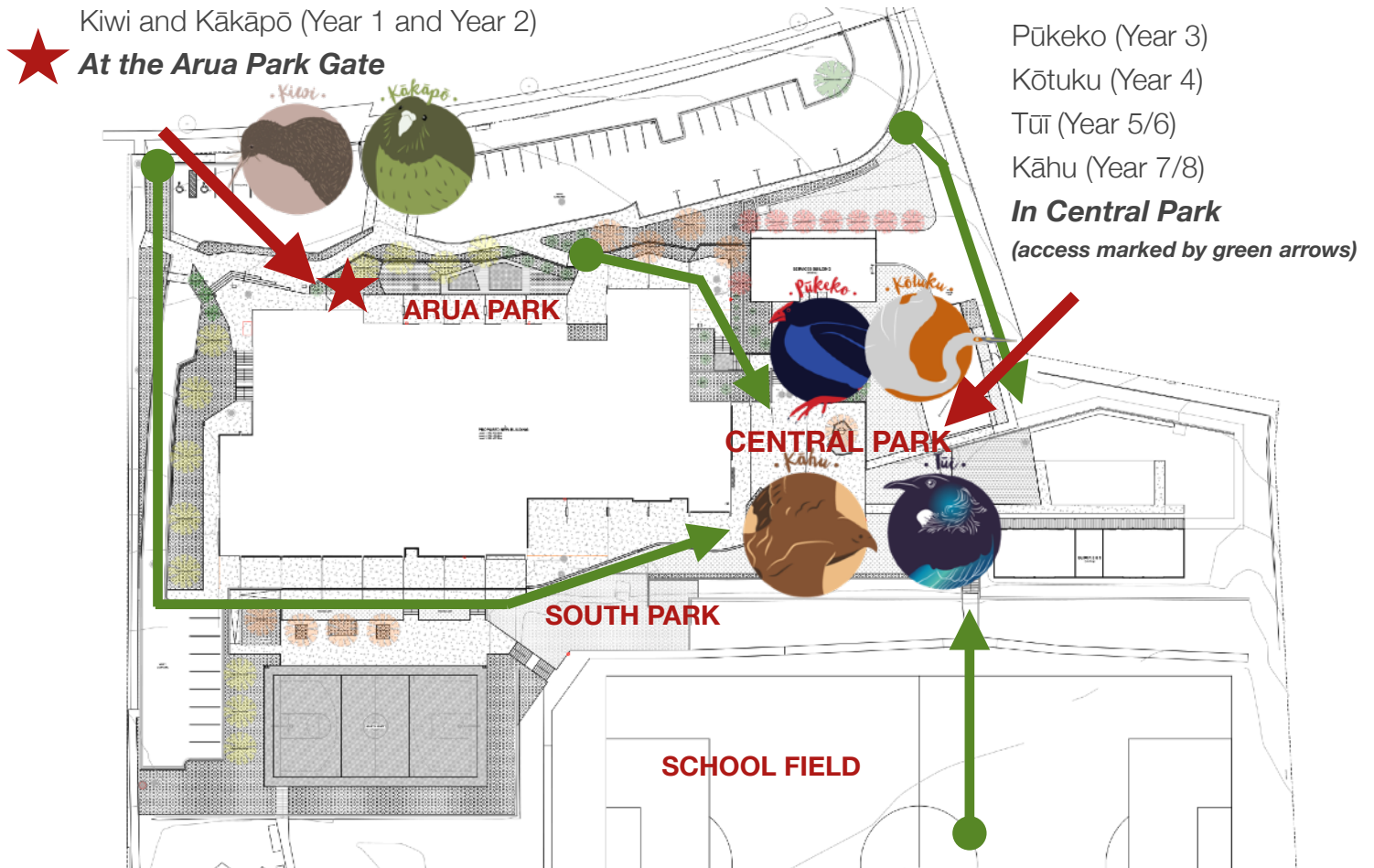

Drop off from Day 2 onwards

From Wednesday 1st February, **all students are to be dropped off** at their allocated entry point **from 8.20am**.

Kiwi and Kākāpō at the Arua Park Gate. Staff will be at the gate to welcome them in.

All students from Year 3-8 enter school at the Library Doors in Central Park. Staff will be at doors to welcome them in.

Important Reminders

SAVE THE DATE: Tuesday 7th February, 5pm. Open Night - Meet the Teachers

Friday Drop In

Parents are invited into teaching spaces every **Friday morning from 8.20am - 8.50am**. This is a great opportunity for your child to show you around their space and share what they have been up to.

Teachers are still available every day at the Arua Gates and Library doors if you have any questions you need to ask.

Before and After School Care

Great Times will be running before and after school care options for families, based out of the Weka block. Please contact them directly for more information: Trish Le Prou - 0275180077 or email alecas@xtra.co.nz

Important Reminders cont.

School lunches

Options for purchasing school lunches will not begin until the term is underway and we will let you know when this is up and running. All students need to have morning tea and lunch in a named lunchbox, every day.

Stationery Orders: 2023

You will have already received the information for how to order your child's stationery. If you have not yet done so, please go to this link <https://www.myschool.co.nz/> and enter The Gardens School, to see the requirements list for each Hapori.

Please ensure you order the full list of items for each child. We endeavour to keep stationery requirements to the minimum, and everything that is listed is required. We choose to use Office Max for quality and consistency, particularly with exercise books, as these can vary greatly between brands, so please do not substitute items.

BYOiPAD: Year 5, 6, 7 & 8

Students from Year 5 upwards are asked to bring an Apple iPad to school. Information about our BYOiPad programme was sent to all Year 4 families in 2022. The Gardens School runs on an Apple Platform, so Apple iPads (or MacBooks) are the only devices supported at school.

If you have any questions regarding our BYOiPad programme, please contact our Lead Teacher of IT, Christine Hansen, christineh@thegardens.school.nz

School Uniforms

All students must start the new school year, in full correct summer uniform. Sandals are recommend for the summer terms and must be **plain black**. They must stay on well, with a strap around the back of the ankle. School shoes should be appropriate for school (not a fashion shoe), must stay on well and must be **plain black** and worn with **plain black or white ankle socks**.

School hats are compulsory in Term 1. **Year 0-6 students must have the tan bucket hat.**

Any new or replacement items must be purchased in time for the start of the year, via [Argyle Online](#).

For full details about our uniform expectations, please see our website: <http://www.thegardens.school.nz/information/school-uniform/>

Uniform requirements for Year 7/8:

Students in Kāhu (Year 7/8) have a slightly different uniform to the rest of the school. This is designed to identify them as our school leaders.



All Kāhu Year 7/8 students require:

- The BLACK school cap or BLACK bucket hat
- Dark grey intermediate skirt or dark grey intermediate shorts
- All other uniform items remain the same, including plain black shoes or sandals and plain black or white socks.

2023 SCHOOL ORGANISATION

We are pleased to be fully staffed for the start of the 2023 school year and we extend a warm welcome to our new teachers, Mrs Linda Turreda who joins the Tūi Hapori and Miss Ting Wang who joins the Kāhu Hapori.



HAPORI	HAPORI LEADER	TEACHING TEAM
Year 0/1 	Hayley Williams	Hayley Williams Monika Ohari Rowena Seumanu Reem Mesmar Brenda McDonald/Jill Hayward
Year 2 	Paige Starrkley	Paige Starrkley Maria Walsh Jennifer Goodwin Lily Bradshaw Jill Hayward
Year 3 	Amy Luck	Amy Luck Hayley-Ann Botha Preet Saini Carol Kent
Year 4 	Genna Pienaar	Genna Pienaar Natasha Dickison Sara Hayward Anna Howe
Year 5/6 	Hugh Wong	Hugh Wong Chané van Tonder Charlotte Smith Karen Davies Linda Turreda
Year 7/8 	Morgan Rowland	Morgan Rowland Gemma Kelly Dharia Bearda Elizabeth Barrowman Ting Wang
Matanga Hapori: Specialist Teachers	Lisa Cosford	Lisa Cosford - Wellbeing Grace Saleupolu - Music Kate Watson - PE and Sport Viv Lee - Spanish and Textiles Technology Juanita Swanepoel - Food Technology Karen Davies - Enviro Chris van Tonder - Science (<i>on study leave</i>)
Ako Hapori: Learning Support	Sepa Tala'imanu	Sepa Tala'imanu - SENCO Carol Kent - SENCO Tracey Kuba - Learning Support Coordinator
Senior Leadership Team	Principal Deputy Principal Associate Principal Head of IT (<i>Device Principal</i>)	Susannah Fowler Kate Gifford Sepa Tala'imanu Christine Hansen

2023 Hapori Teaching Spaces

ARUA - LEVEL 1

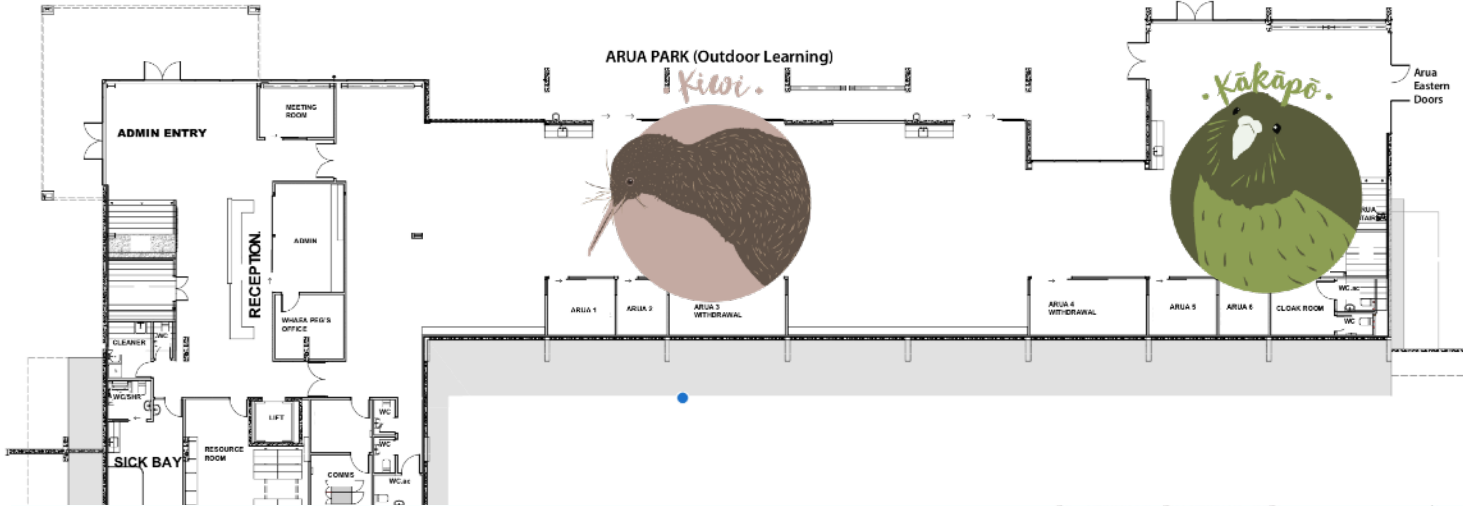

TIWAI - LEVEL 2

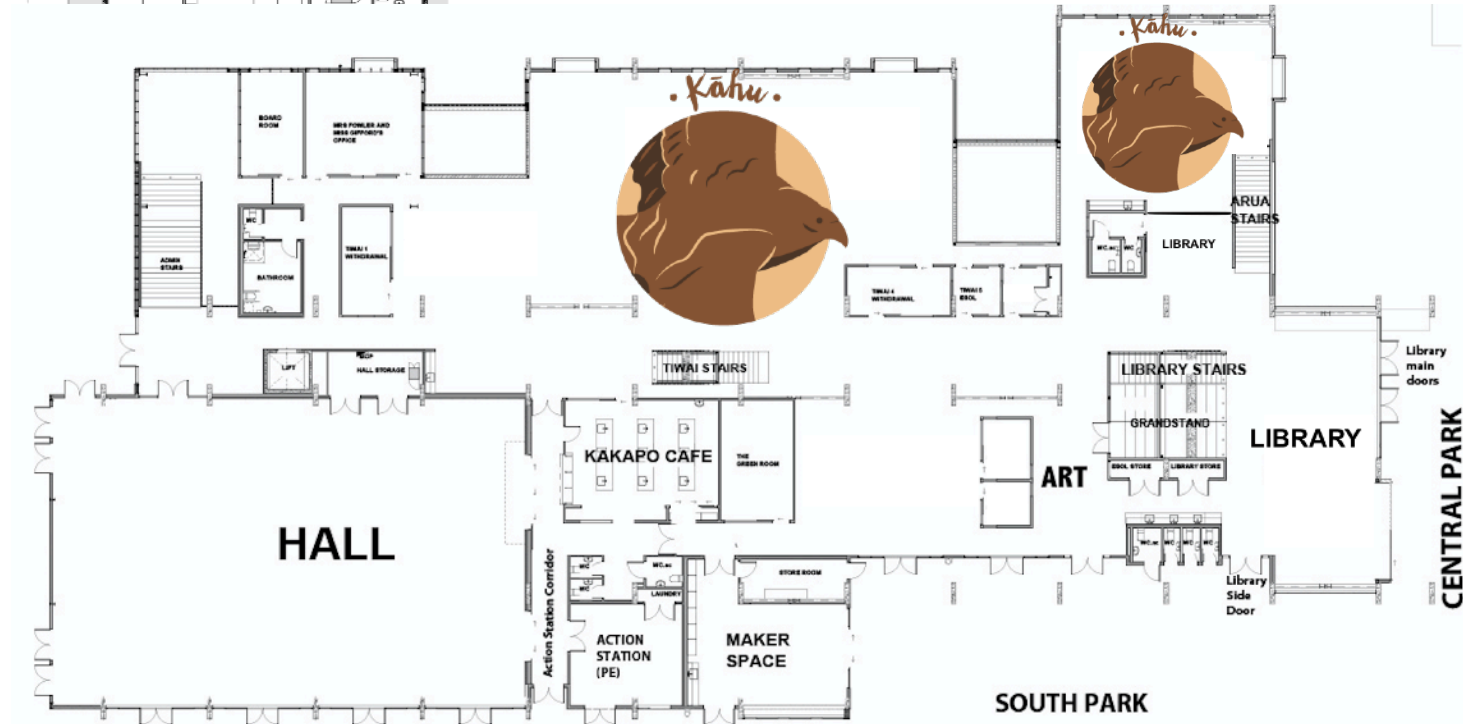

OHUNGA - LEVEL 3

